

The control box is used with all variations of traffic lights. It is supplied with a plug-top power supply with connectivity for all elements of the system. The sensitivity of the contact free switch is set internally, together with mode of operation. By default the sensor is set to latch, but change be changed to a timed operation of approximately 2 to 22 seconds. Within the enclosure, there is a 1 A anti-surge fuse.

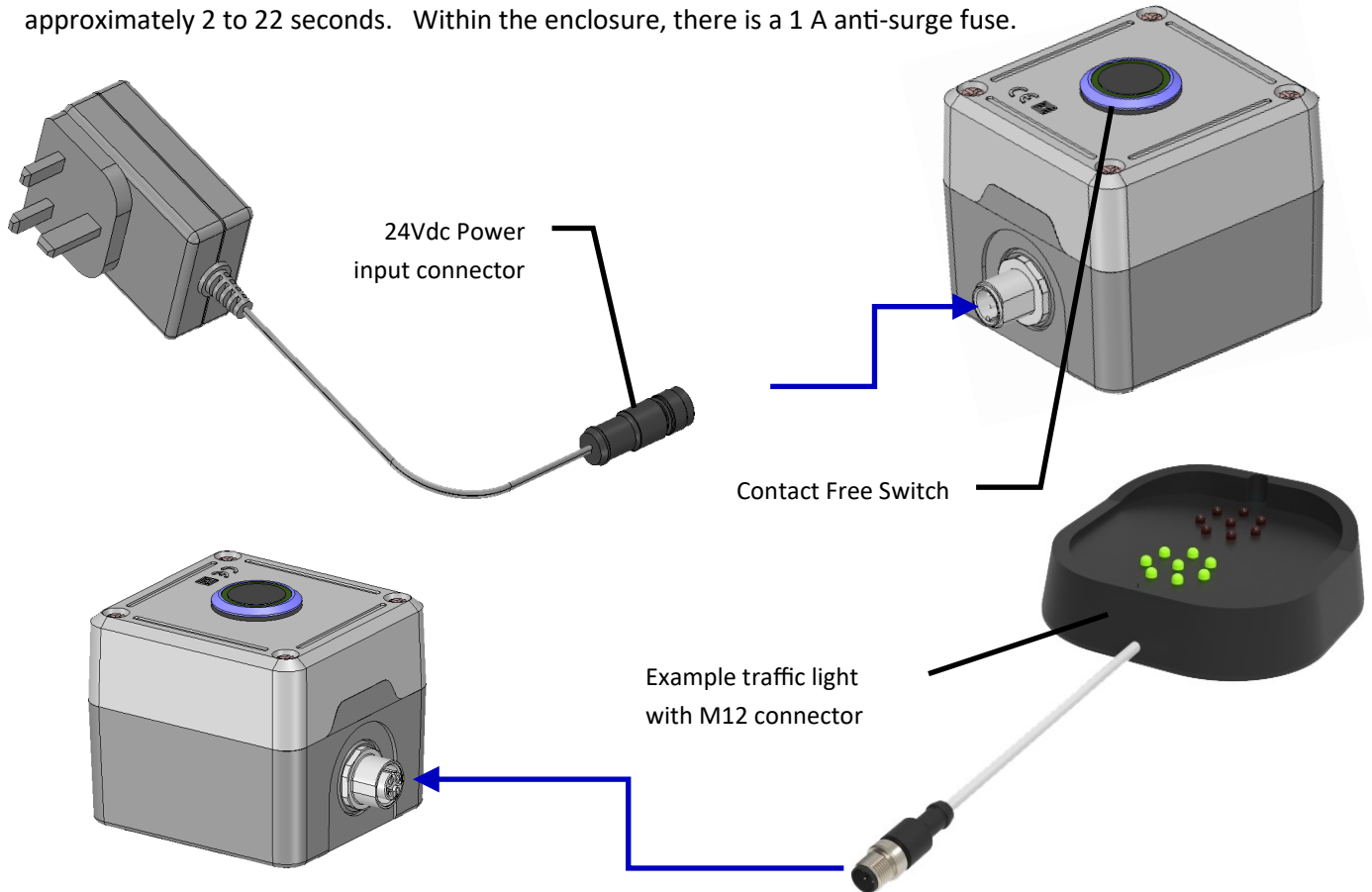

Range (cm)		
5	7.5	15

Duration (seconds)			
0.5	5	10	20

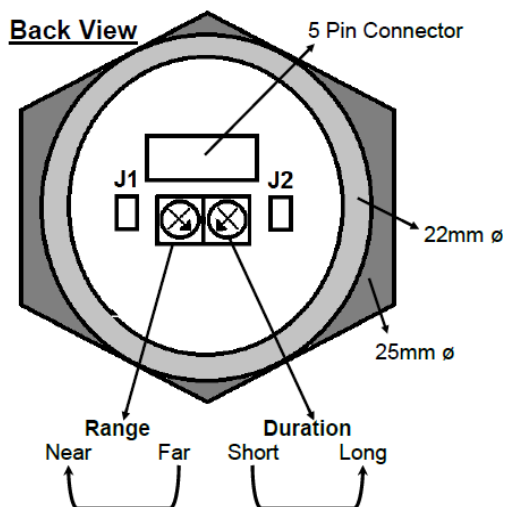

### Rear view of contact free switch.

Default settings:

Range - Mid Point 7.5 cm

Duration - Clockwise Position Latching

The switch can be set as timed operation from 2 to 22 seconds .

When replacing the lid of the control box, take care not to trap and damage any of the wires.

**Motion29 Limited**  
Unit C9, Newbridge Road Industrial Estate  
Pontllanfraith, Blackwood, NP12 2XF, UK.

**Tel: 01495 360022**

www.motion29.com

info@motion29.co.uk

Every effort has been made to ensure the information within this document is correct and accurate as possible, no warranty as to the accuracy of this information is implied in any way. With our policy of continuous development, we reserve the right to vary detail within the document without further notice.